

INDEX

- A1 ISOMETRIC
- A2 FLOOR PLAN
- A3 RAFTER AND JOIST LAYOUT
- A4 FRONT AND LEFT SIDE ELEVATIONS
- A5 REAR AND RIGHT SIDE ELEVATIONS

- A6 SECTIONS
- A7 DETAILS
- A8 DETAILS
- A9 DETAILS

GENERAL NOTES

- 1) ALL FLOOR FRAMING TO BE FASTENED WITH 3 1/4" HG NAILS
- 2) ALL WALL AND ROOF FRAMING TO BE FASTENED WITH 3 1/4" PC NAILS
- 3) ALL WALL SHEATHING AND TRIM TO BE SECURED WITH 2" SIDING NAILS
- 4) ROOF SHEATHING TO NAILED WITH 2" SIDING NAILS ON 1 SIDE ONLY, OTHER SIDE CUT AND LEFT OFF
- 5) DECKING TO BE SECURED WITH DECKING SCREWS
- 6) BRACES TO BE SECURED WITH DECKING SCREWS
- 7) FLOOR SHEATHING TO BE SECURED WITH SCREWS

No.	Revision / Issue	Date



Provincial
Secondary Project

<small>DRAWING:</small> ISOMETRIC	<small>SHEET #</small>
<small>DATE:</small> 01/03/2020	A1
<small>SCALE:</small> NOT TO SCALE	

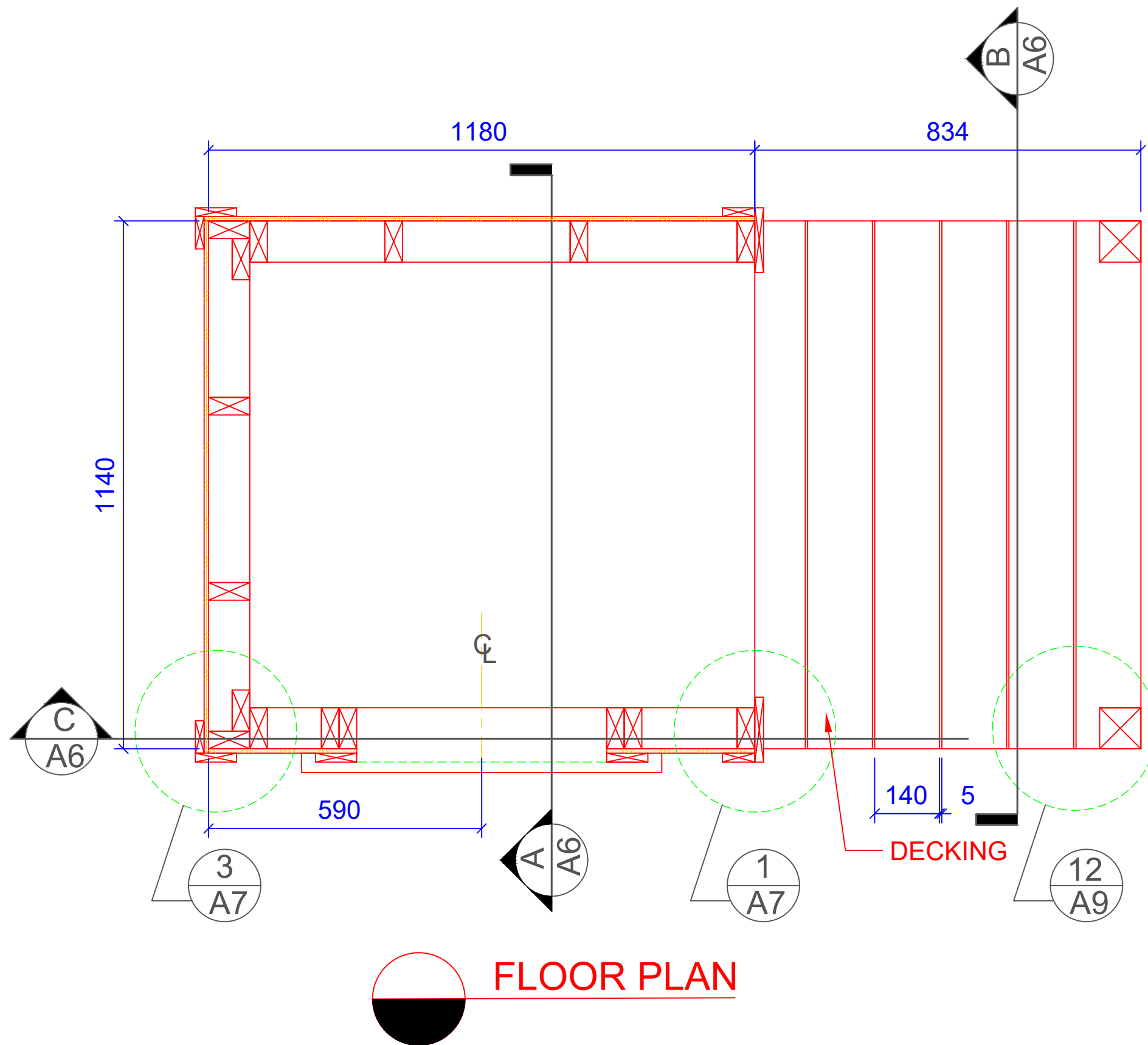

GENERAL NOTES

(FOR EDUCATIONAL PURPOSES ONLY)

- 1) ALL SHEATHING STOCK TO BE VERIFIED ON SITE
- 2) MEASUREMENTS TO EDGE OF FRAMING
- 3) FINISH/SOFTEN ALL EXPOSED EDGES
- 4) ALL FRAMING AT 400 O/C
- 5) FLOOR SHEATHING 19MM SPF
- 6) WALL SHEATHING LAPPING FLOOR FRAMING BY 50mm

No.	Revision / Issue	Date



Provincial
Secondary Project

DRAWING: FLOOR PLAN	SHEET # A2
DATE: 01/03/2020	
SCALE: NOT TO SCALE	

GENERAL NOTES

(FOR EDUCATIONAL PURPOSES ONLY)

- ACQ FLOOR FRAMING

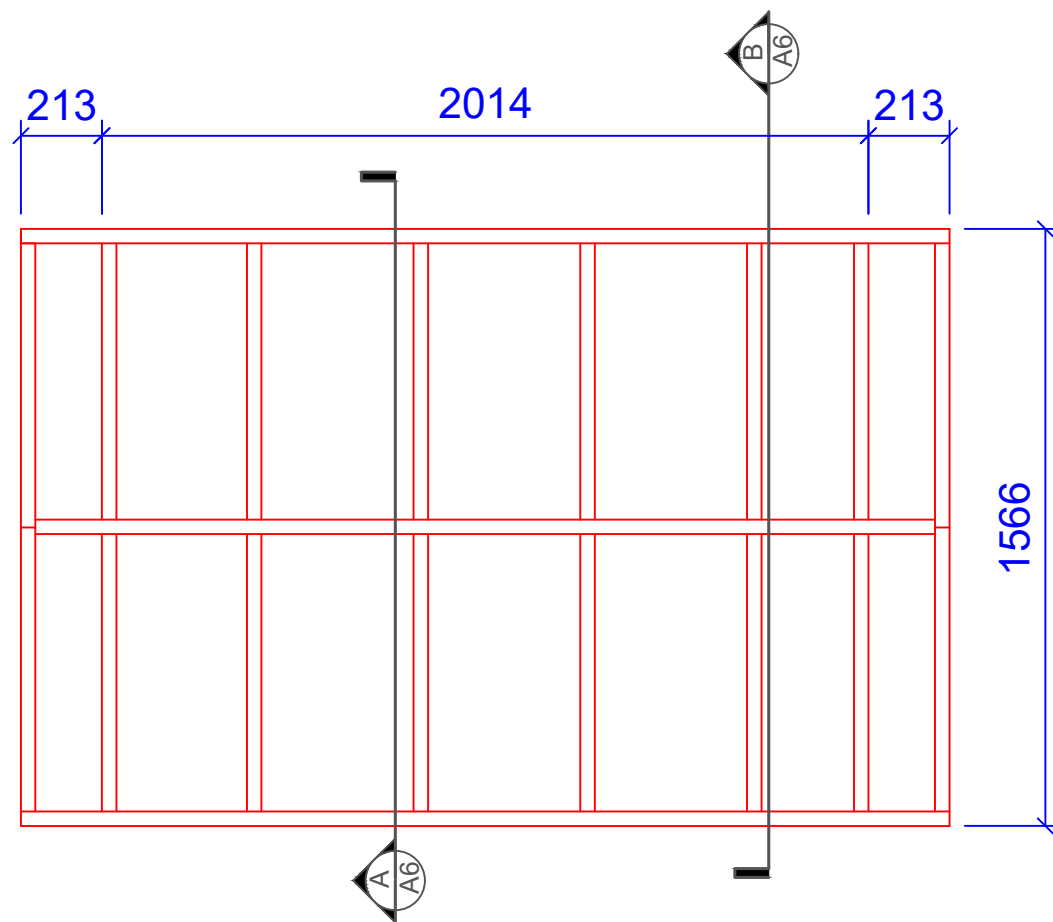

 **PLAN-RAFTERS**

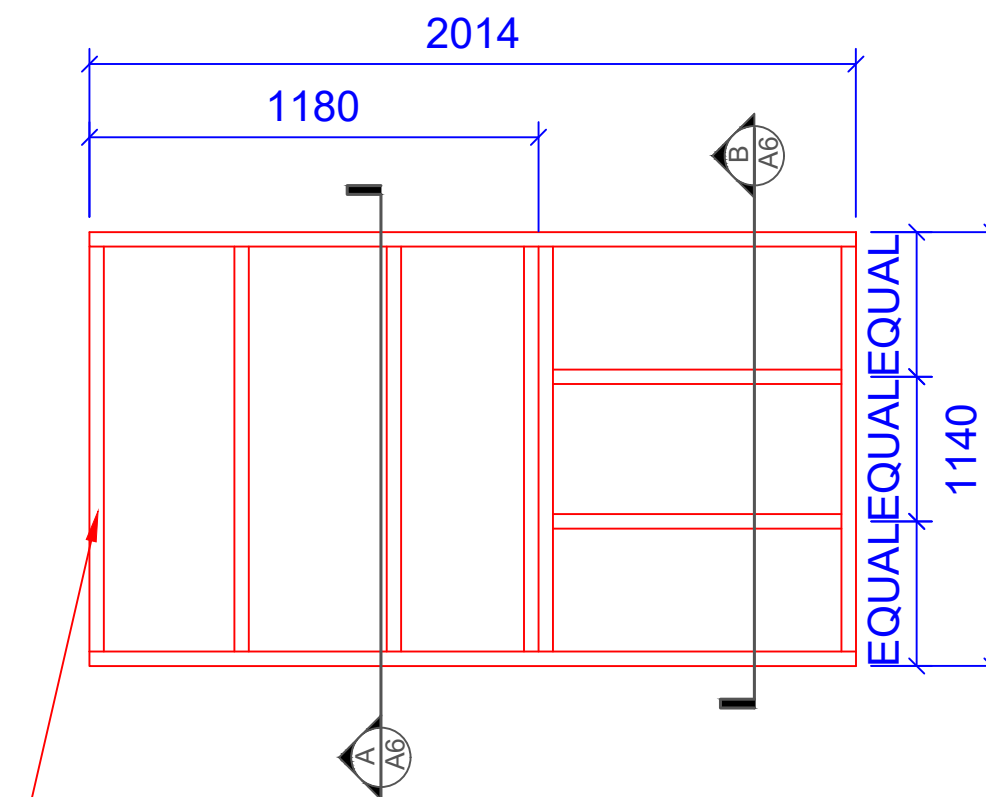

JOIST LAYOUT 400 O/C
BEGINNING AT REAR

 **FLOOR JOIST PLAN**

No.	Revision / Issue	Date



Provincial
Secondary Project

DRAWING: RAFTER/JOIST LAYOUT	SHEET #
DATE: 01/03/2020	A3
SCALE: NOT TO SCALE	

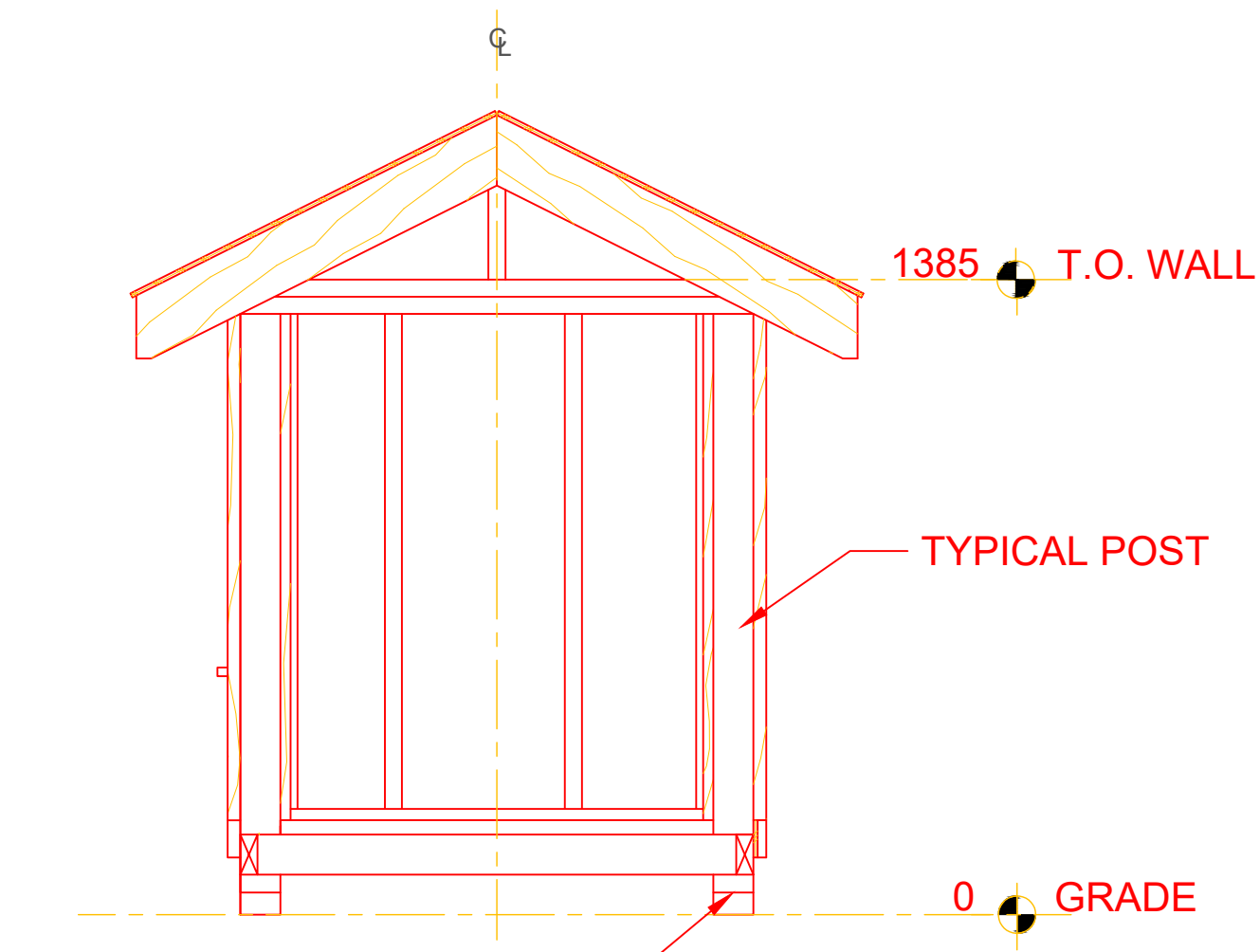

LINE OF BEVEL @ SLEEPER ENDS

FRONT-ELEVATION

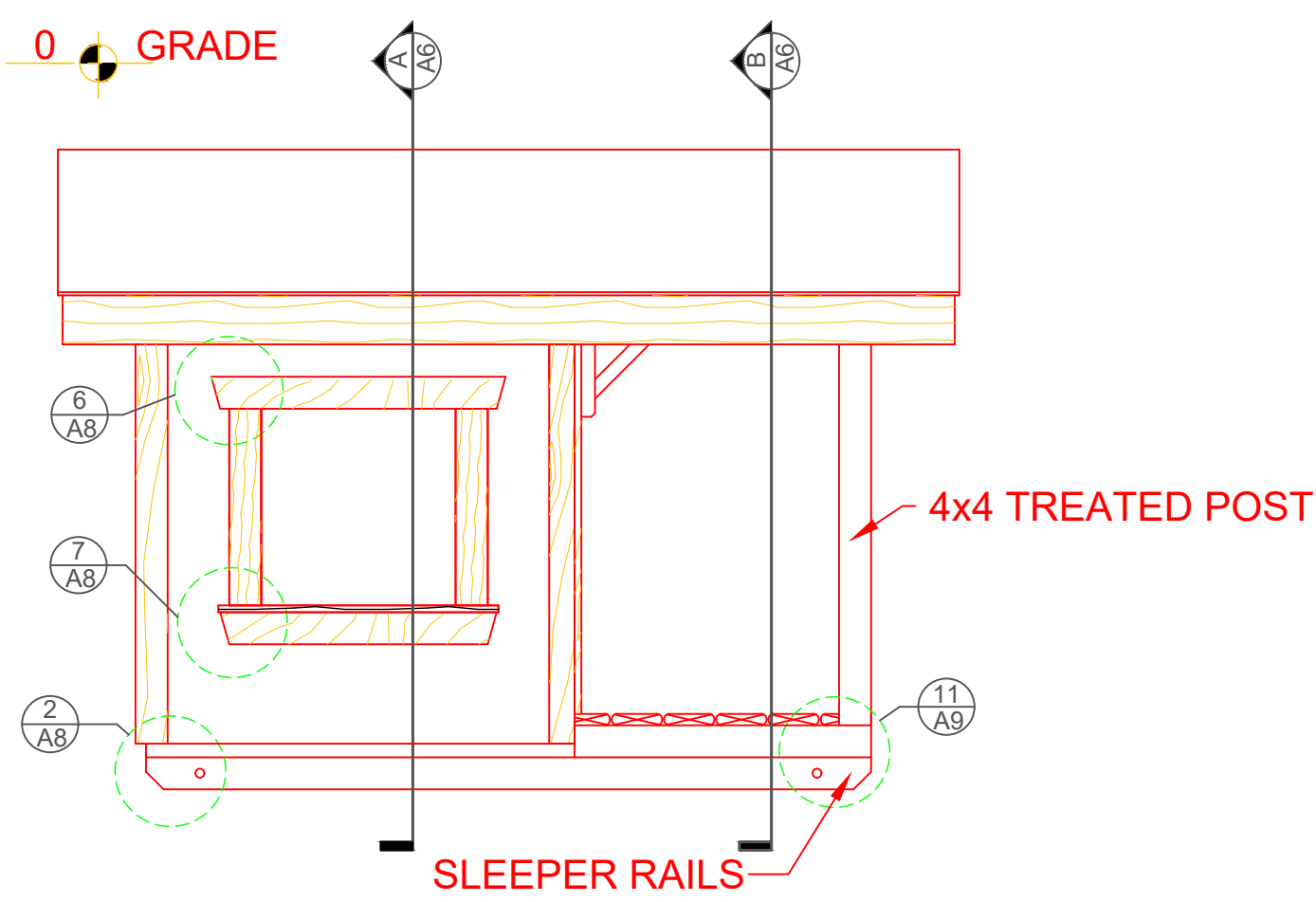

LEFT SIDE-ELEVATION

- GENERAL NOTES**
(FOR EDUCATIONAL PURPOSES ONLY)
- 1) FINISH FASCIA MITERED AT CORNERS
 - 2) SLEEPER RAILS - 4X4 TREATED

No.	Revision / Issue	Date



Provincial
Secondary Project

DRAWING: ELEVATIONS	SHEET #
DATE: 01/03/2020	A4
SCALE: NOT TO SCALE	

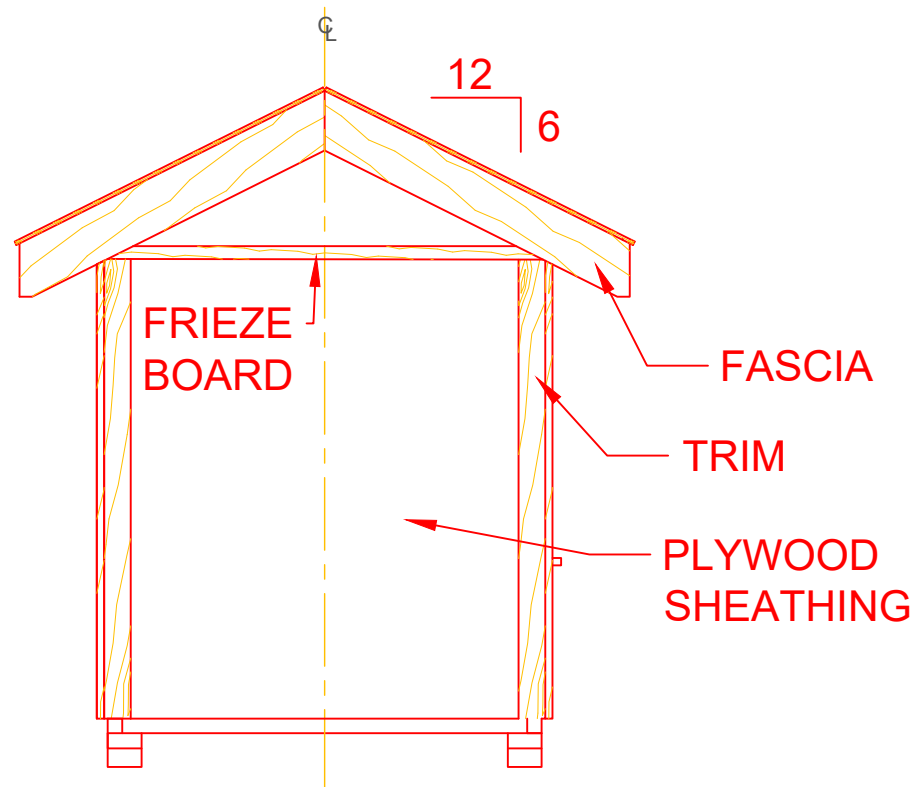

REAR-ELEVATION

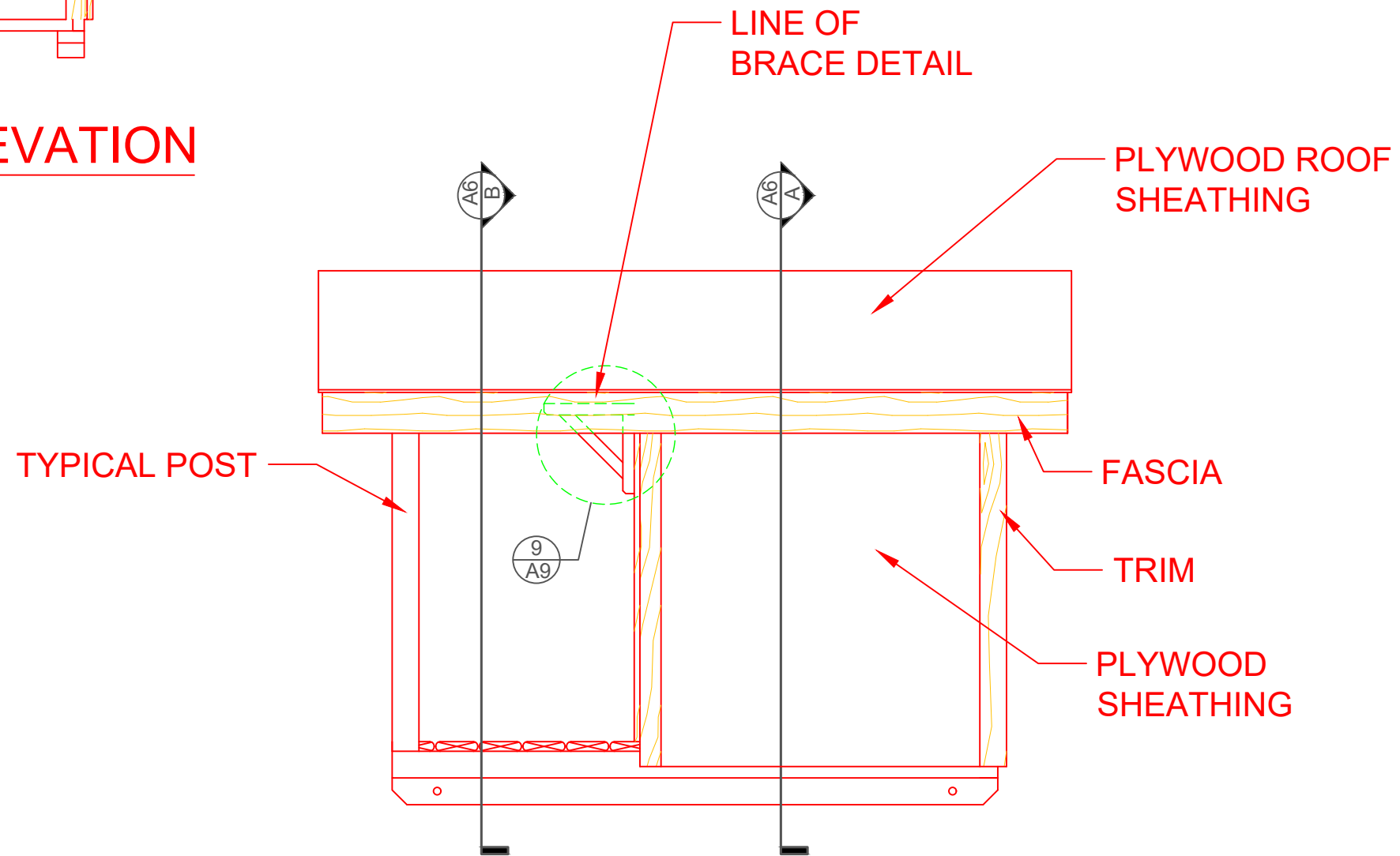

RIGHT SIDE-ELEVATION

GENERAL NOTES
(FOR EDUCATIONAL PURPOSES ONLY)

No.	Revision / Issue	Date



Provincial
Secondary Project

DRAWING: ELEVATIONS	SHEET #
DATE: 01/03/2020	A5
SCALE: NOT TO SCALE	

GENERAL NOTES

(FOR EDUCATIONAL PURPOSES ONLY)

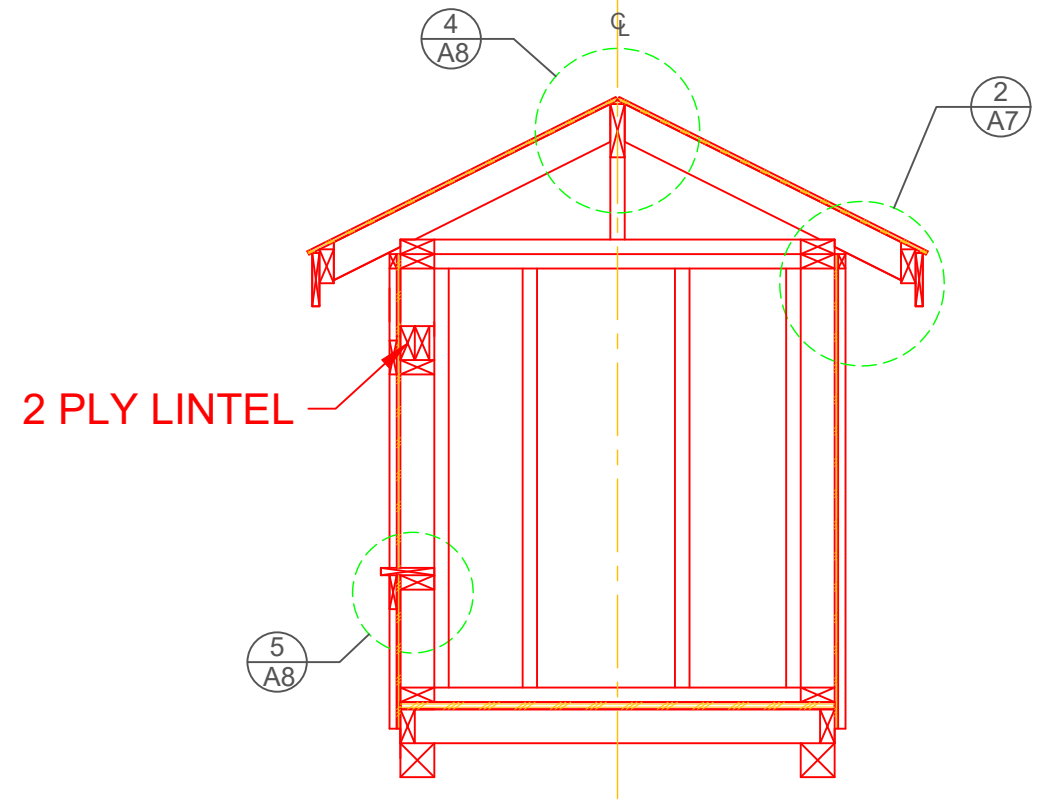

SECTION-A
A2, A3, A4, A5

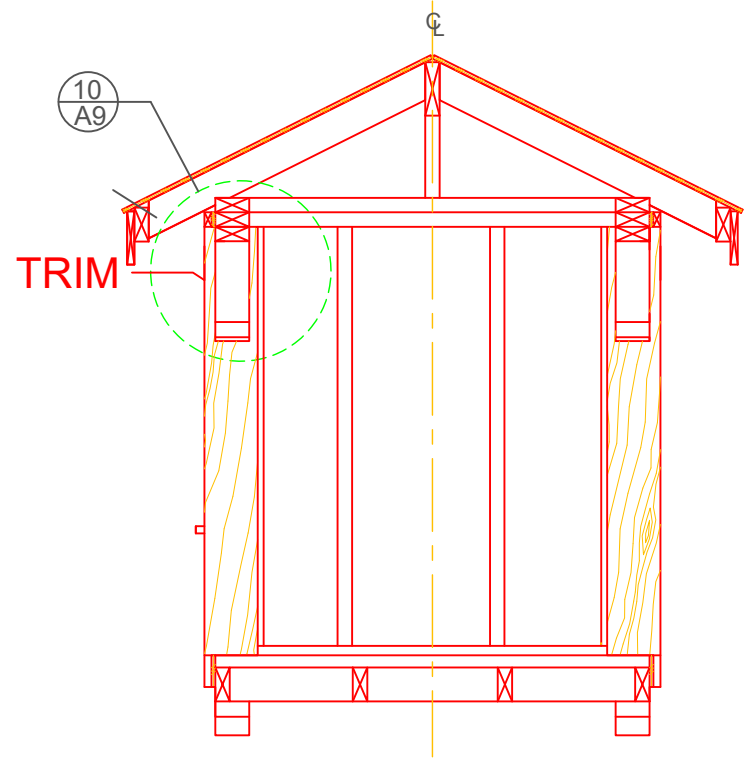

SECTION-B
A2, A3, A4, A5

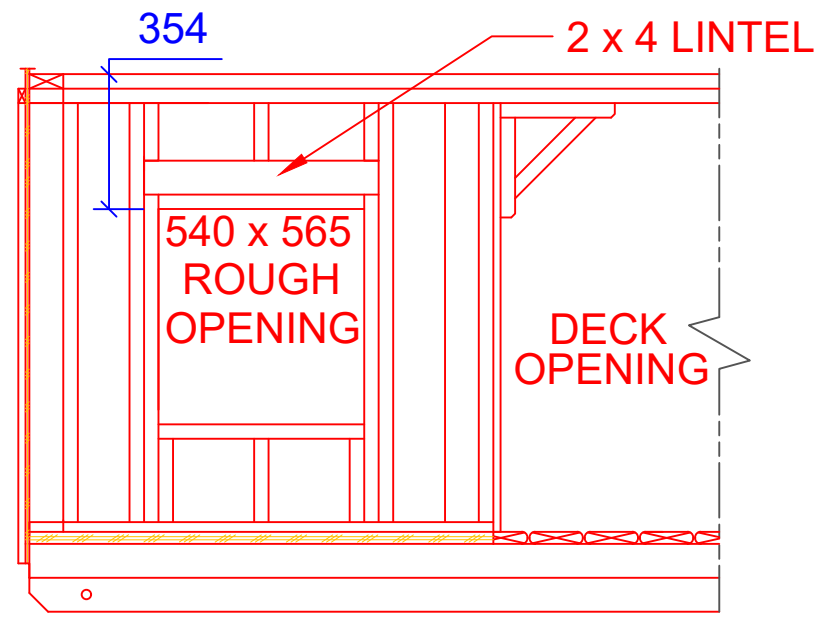

SECTION-C
A2

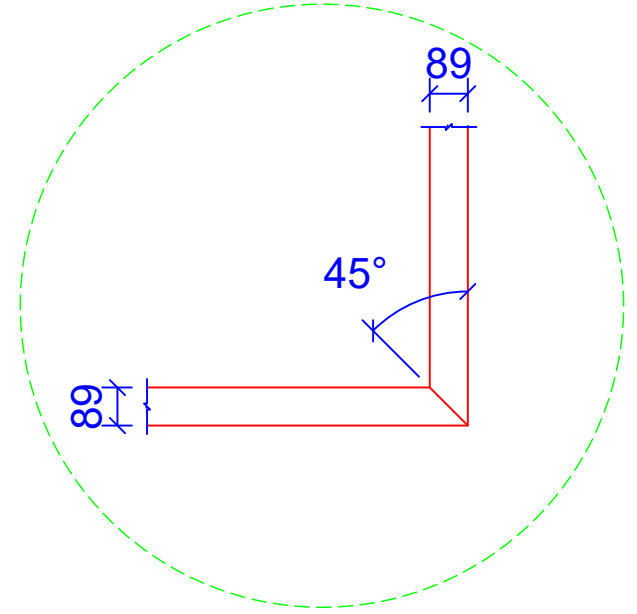

1 TOP PLATE DETAIL AT POST

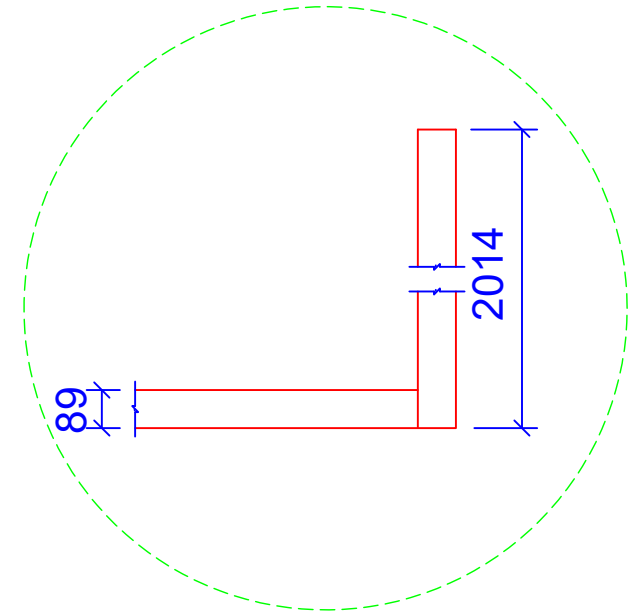

2 CAP PLATE DETAIL AT POST

No.	Revision / Issue	Date



Provincial
Secondary Project

DRAWING: SECTIONS	SHEET #
DATE: 01/03/2020	A6
SCALE: NOT TO SCALE	

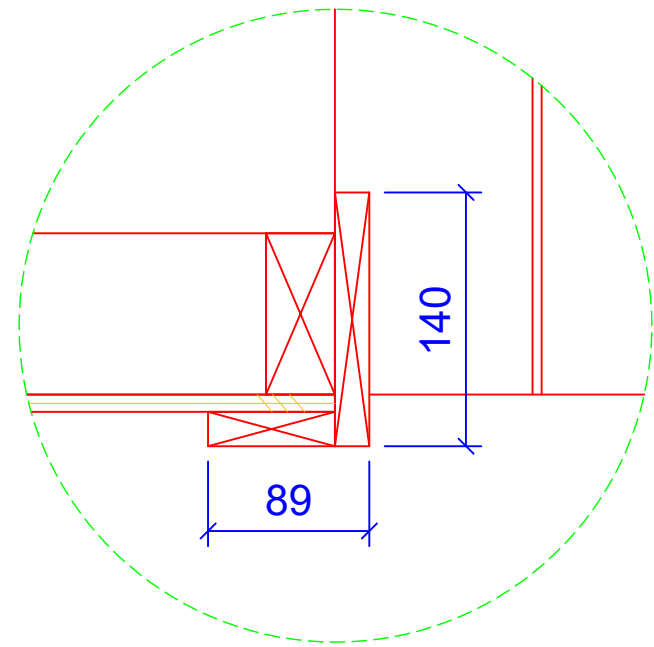

1 FRONT WALL @ CORNERS
A2

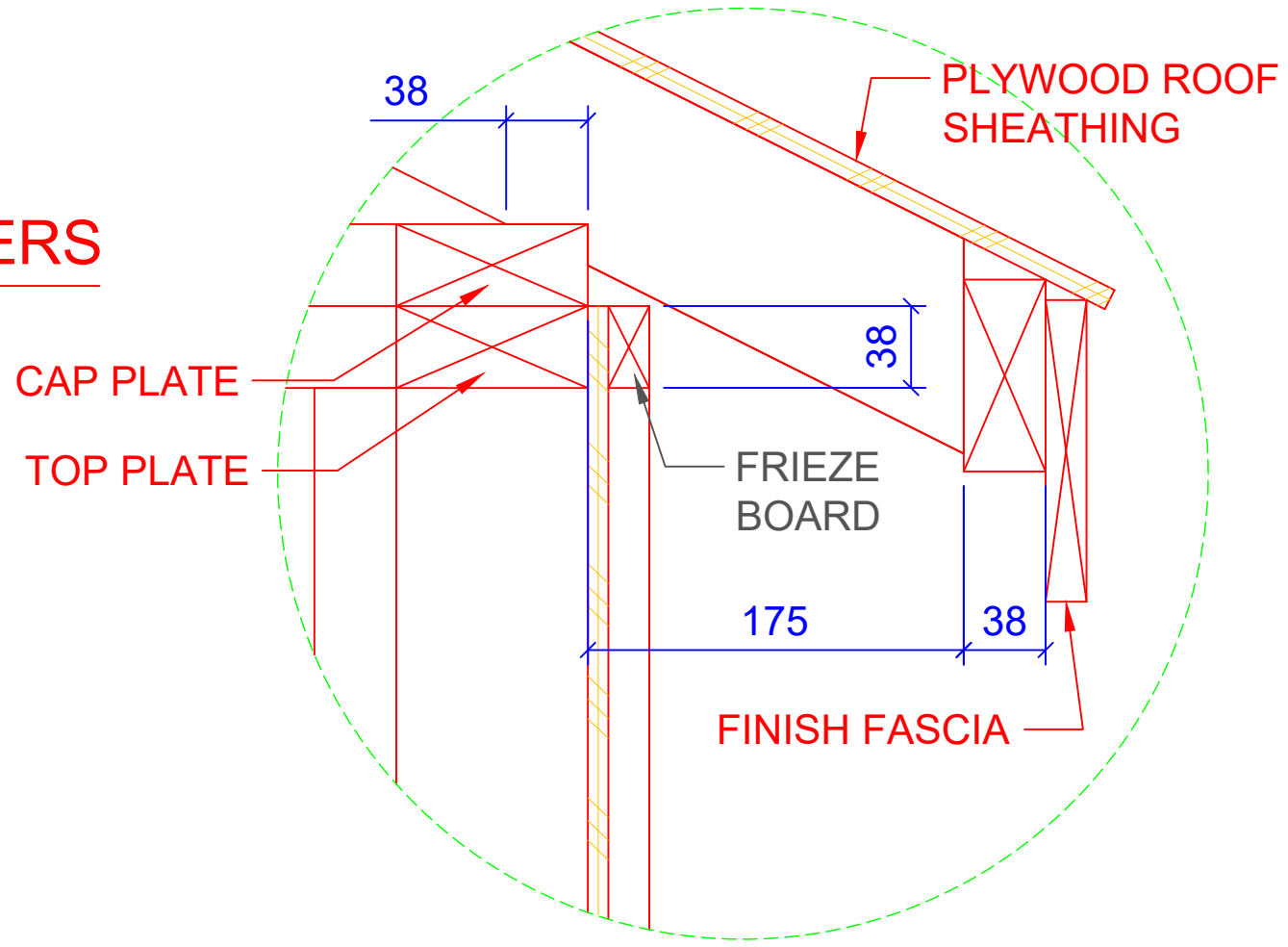

2 TYP. EAVE DETAIL
A6

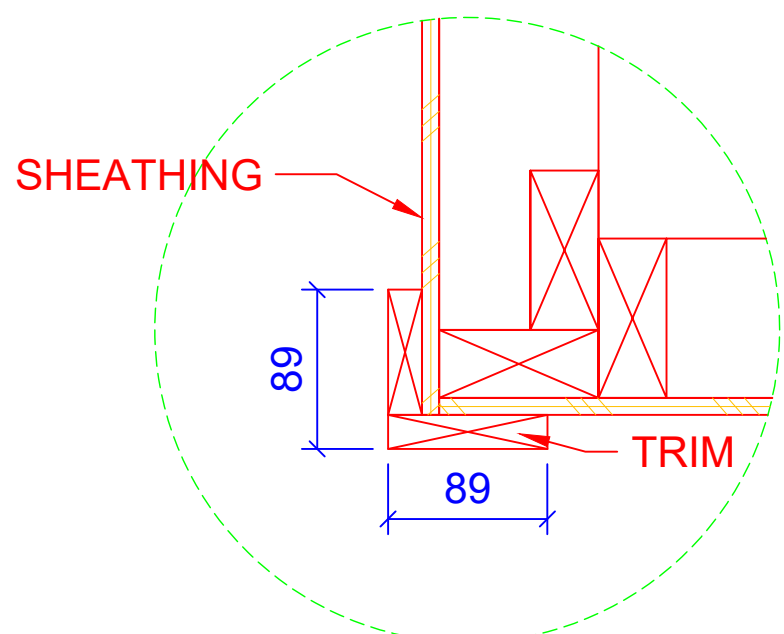

3 BACK WALL @ CORNERS
A2

GENERAL NOTES

(FOR EDUCATIONAL PURPOSES ONLY)

- 1) ROUGH FASCIA - 38X89
- 2) FINISH FASCIA - 19X140

No.	Revision / Issue	Date



Provincial Secondary Project

DRAWING: DETAILS	SHEET #
DATE: 01/03/2020	A7
SCALE: NOT TO SCALE	

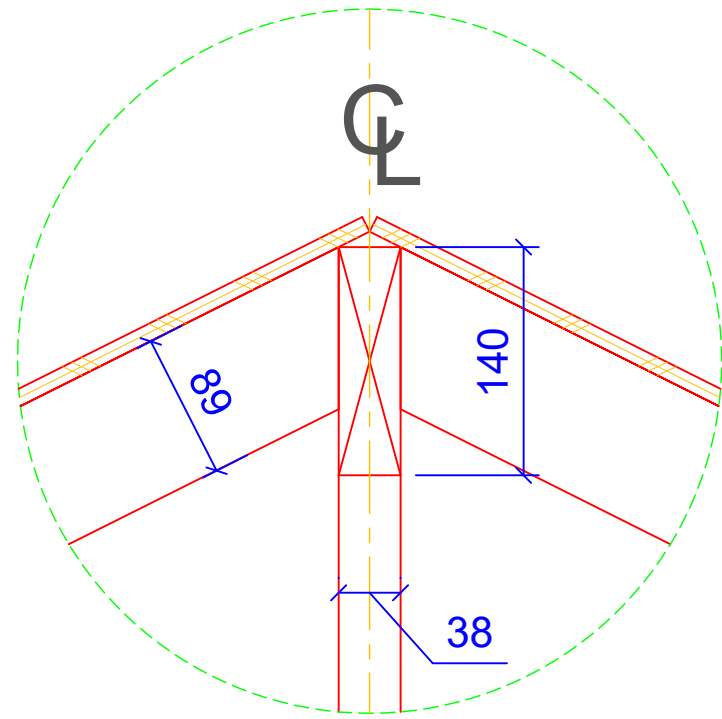

4 RIDGE DETAIL
A6

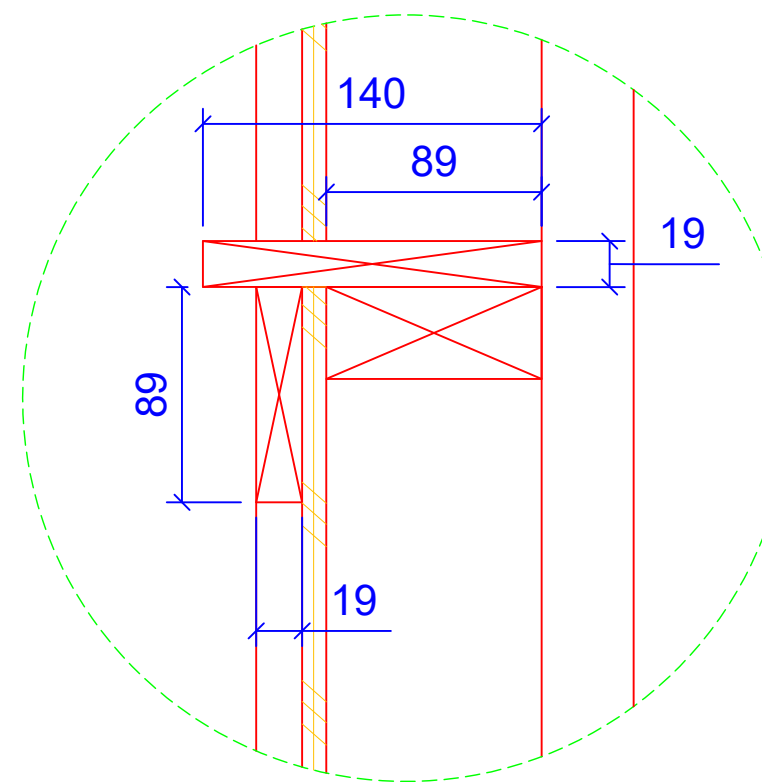

5 WINDOW SILL
A6

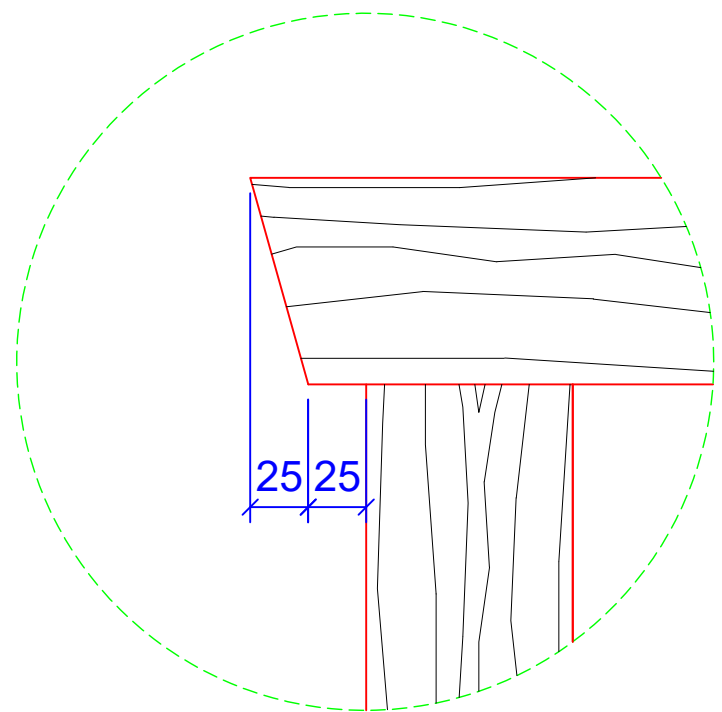

6 WINDOW HEAD TRIM
A4

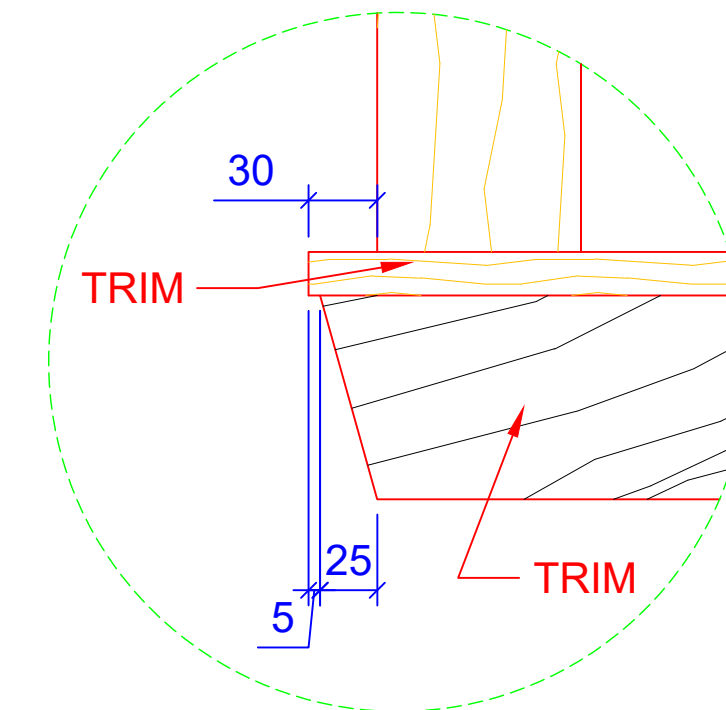

7 WINDOW SILL TRIM
A4

GENERAL NOTES

(FOR EDUCATIONAL PURPOSES ONLY)

No.	Revision / Issue	Date



Provincial
Secondary Project

DRAWING: DETAILS	Sheet #
DATE: 01/03/2020	A8
SCALE: NOT TO SCALE	

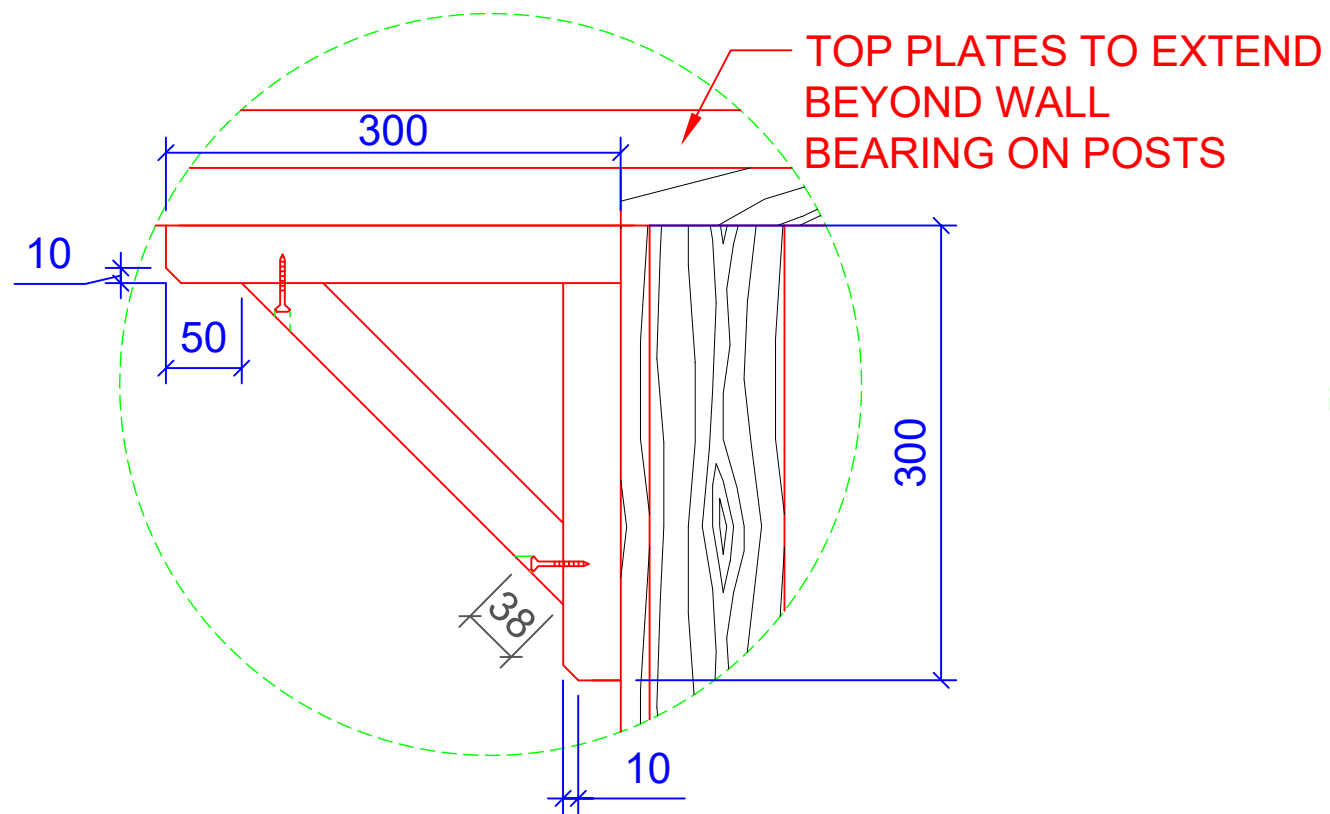

9 BRACE DETAIL-SIDE
A5

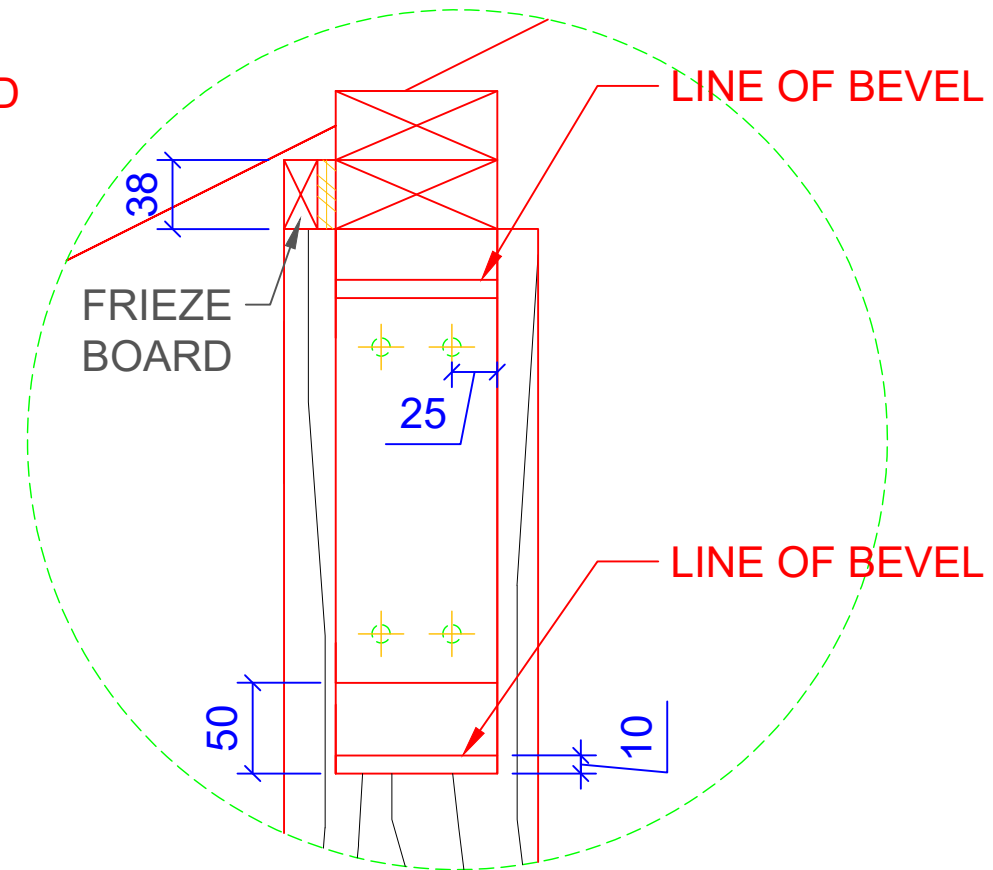

10 BRACE DETAIL-FRONT
A6

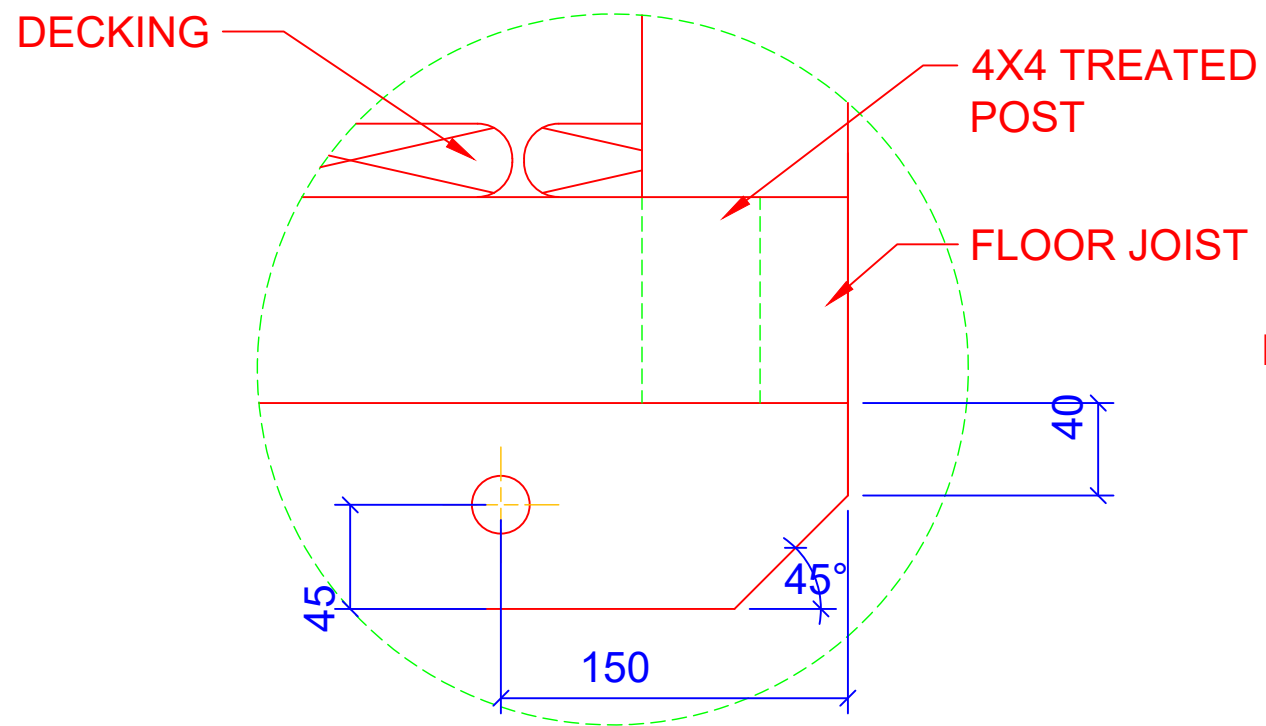

11 FLOOR JOIST @ FRONT POST
A4

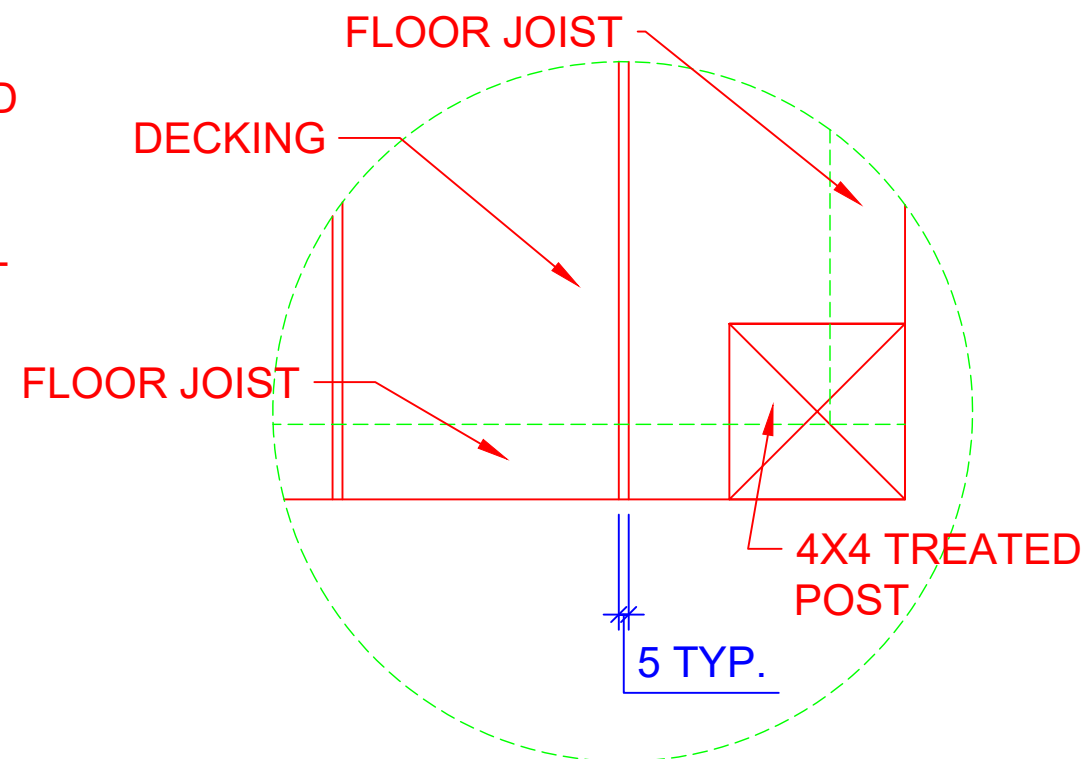

12 DECKING @ FLOOR JOIST
A2

GENERAL NOTES

(FOR EDUCATIONAL PURPOSES ONLY)

- 25 mm dia. hole in Sleeper

No.	Revision / Issue	Date



Provincial Secondary Project

DRAWING: DETAILS	SHEET #
DATE: 01/03/2020	A9
SCALE: NOT TO SCALE	