

Pencil Box



Video Tutorial

Skills Canada Alberta is a provincial non-profit organization that actively promotes careers in skilled trades and technologies to Alberta youth. We do this through unique hands on programming, which includes in-the classroom resources and the Provincial Skills Canada Competition.



What's Included

- 10 nail and wood kits
- 2 wood glue
- Sandpaper
- Painter's Tape
- Brad Nails
- Safety glasses
- Safety gloves

What You Will Need

- Hammer
- Pencil
- Command Square or Ruler

Tag us in your projects! **#ABisSkilled**

Sliding Top Pencil Box



What's Included

- Wood kit – 7 pieces (1:13)
- Nails

What You Will Need (0:40)

- Glue
- Tape
- Sand Paper
- Pencil
- Ruler
- Paper towel
- Hammer
- Gloves
- Glasses

Step 1: Sanding (1:34)

- Sand all the corners, edges and grooves on all pieces

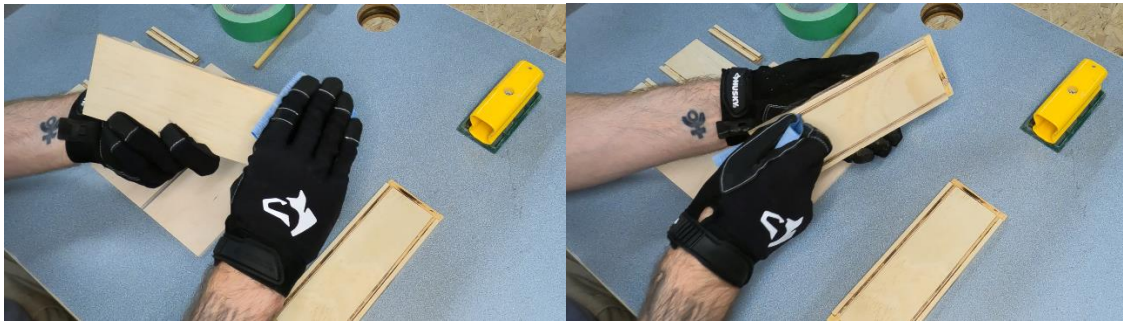

Step 2: Identify and mark pieces (2:05)

- 1- Pull tab for sliding top
- 2- Front side piece, short – 1 groove
- 3- Back side piece, tall – 2 grooves
- 4- Top and bottom piece (x2 – identical)
- 5- Long side pieces (x2 – identical)

Note: Pieces with 2 grooves – 1 groove will be wider for the top to slide in

Find the wider groove on pieces 3 and 5, and mark them with a 'T' for Top



Step 3: Dry Assembly (3:10)

Put all the pieces together without glue. Test to make sure they fit together and sand pieces to fit if needed

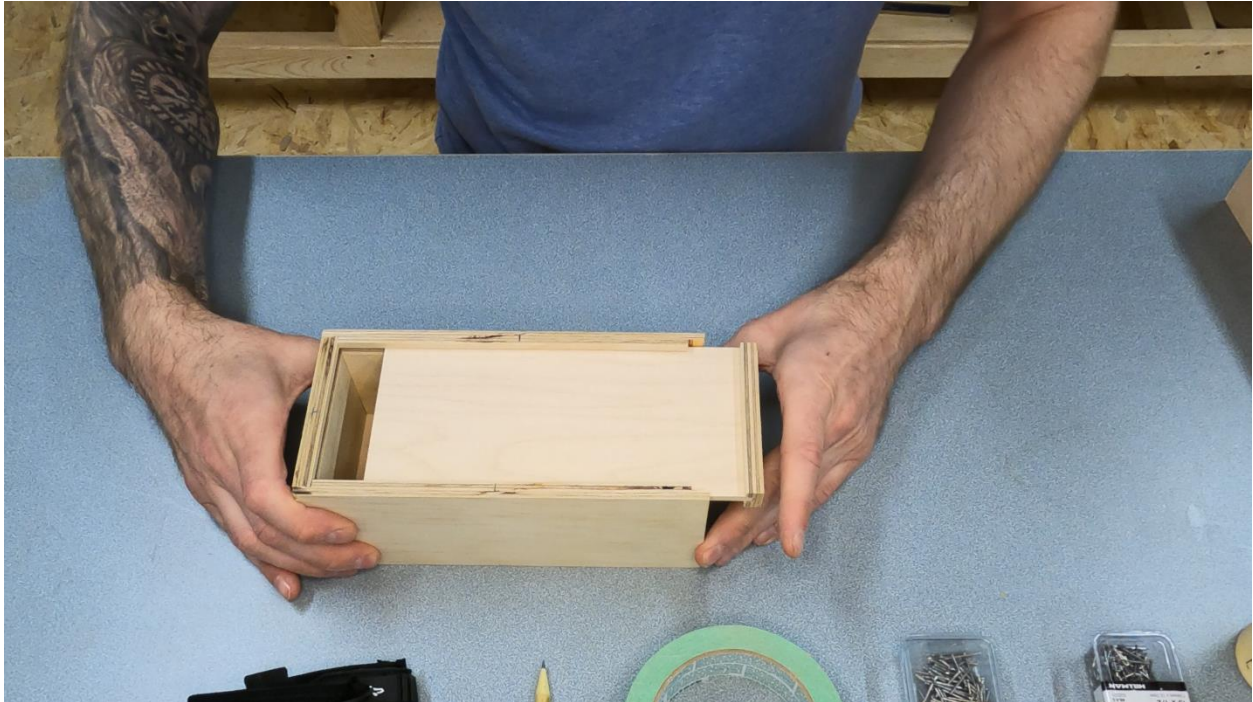

Step 4: Glue the top (4:38)

Apply a small amount of glue to the Pull Tab groove (Piece #1). Center the top box top in the groove and push into place. Apply a small amount of tape to hold it in place while the glue dries.

Note: DO NOT add nails to the top, it is too thin



Step 5: Glue the box (5:16)

With the box still assembled without glue. Mark the places where the top will slide in/out and DO NOT put glue in these places-Inside the top groove and where the pull tab will sit (as shown below)

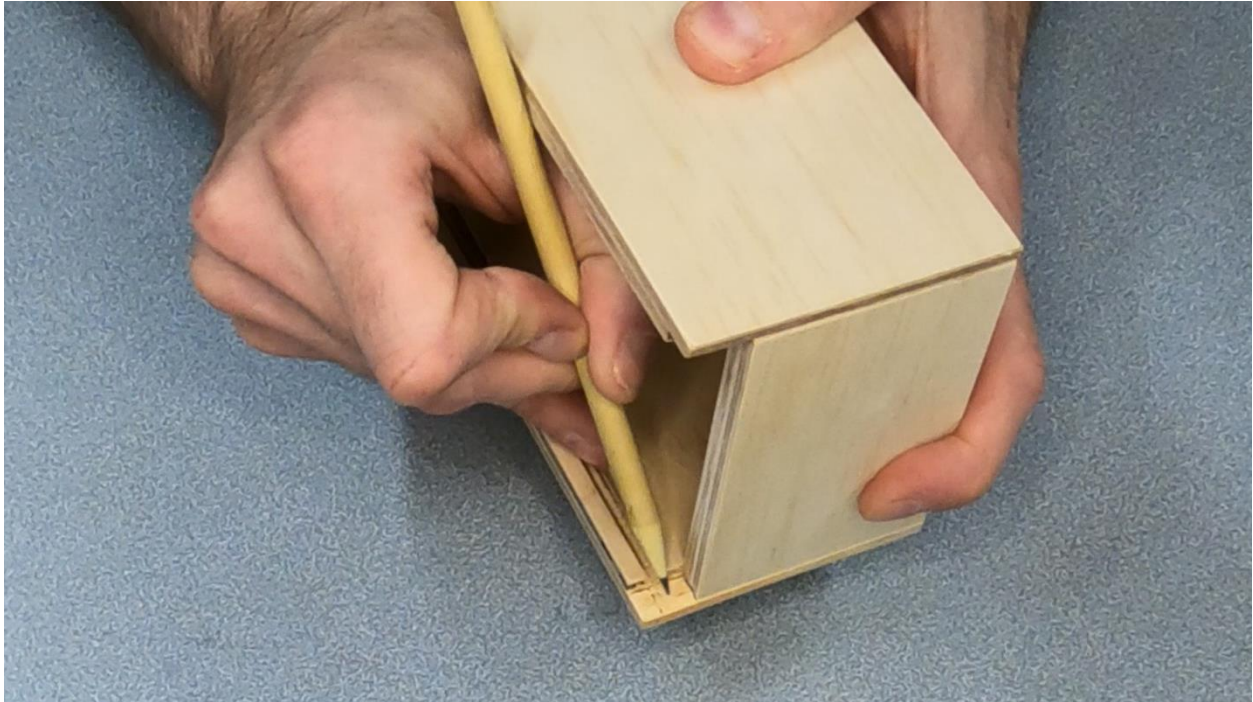

Disassemble the box and add a small amount of glue to the 4x grooves where the bottom will go.

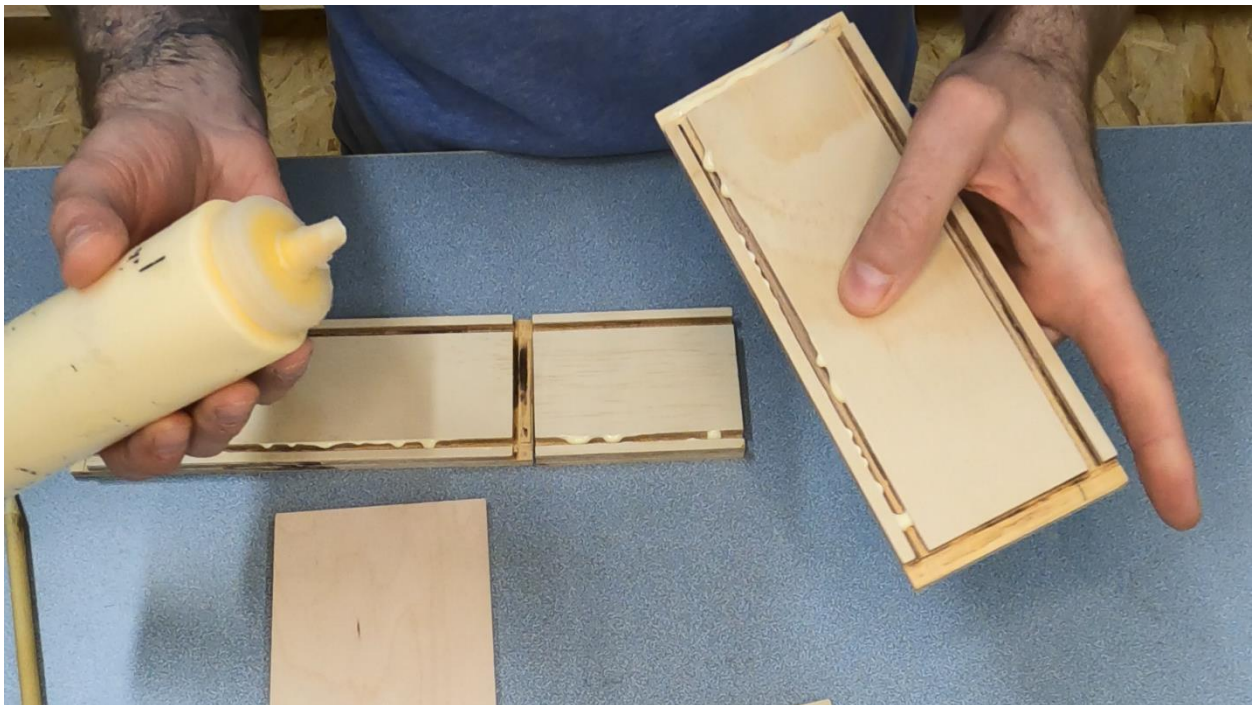

Add glue to the 2 grooves on the inside of Piece #5.



Add a few dots of glue to the sides of Pieces #2 & #3

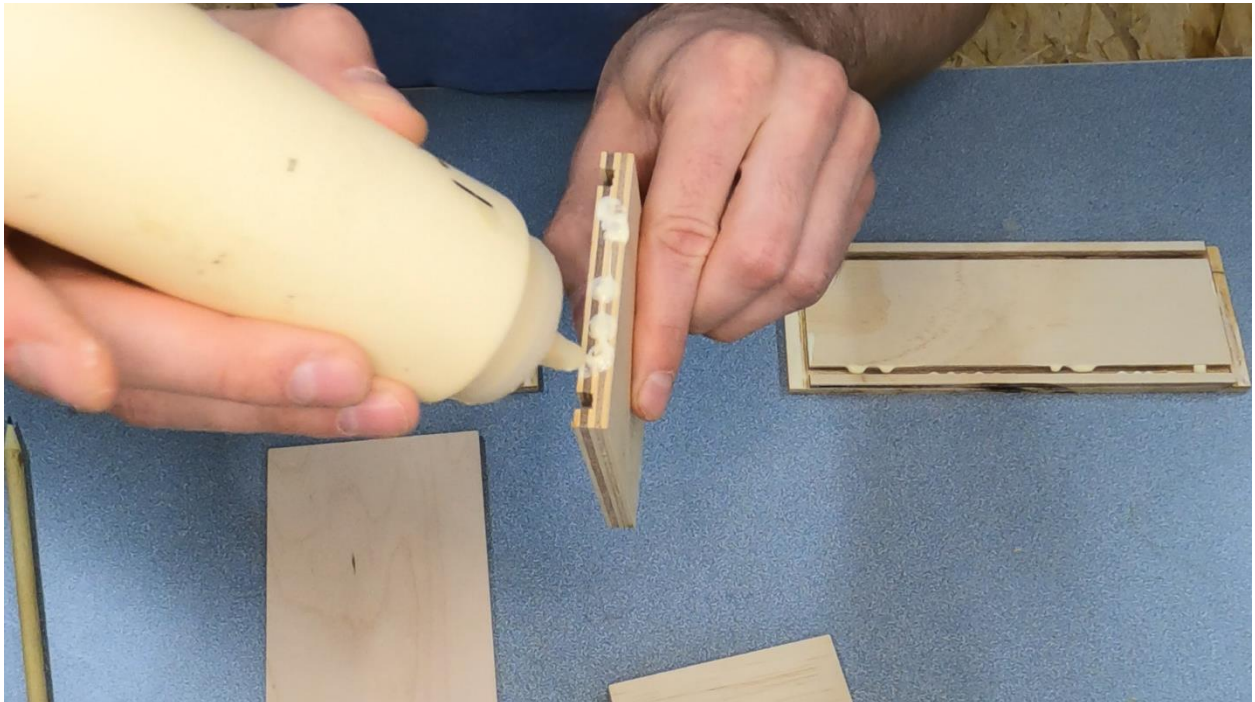

Assemble the box, slide the top in to help keep it square and make sure it slides properly. Add tape to the 4 corners. Wipe up any excess glue with a paper towel.

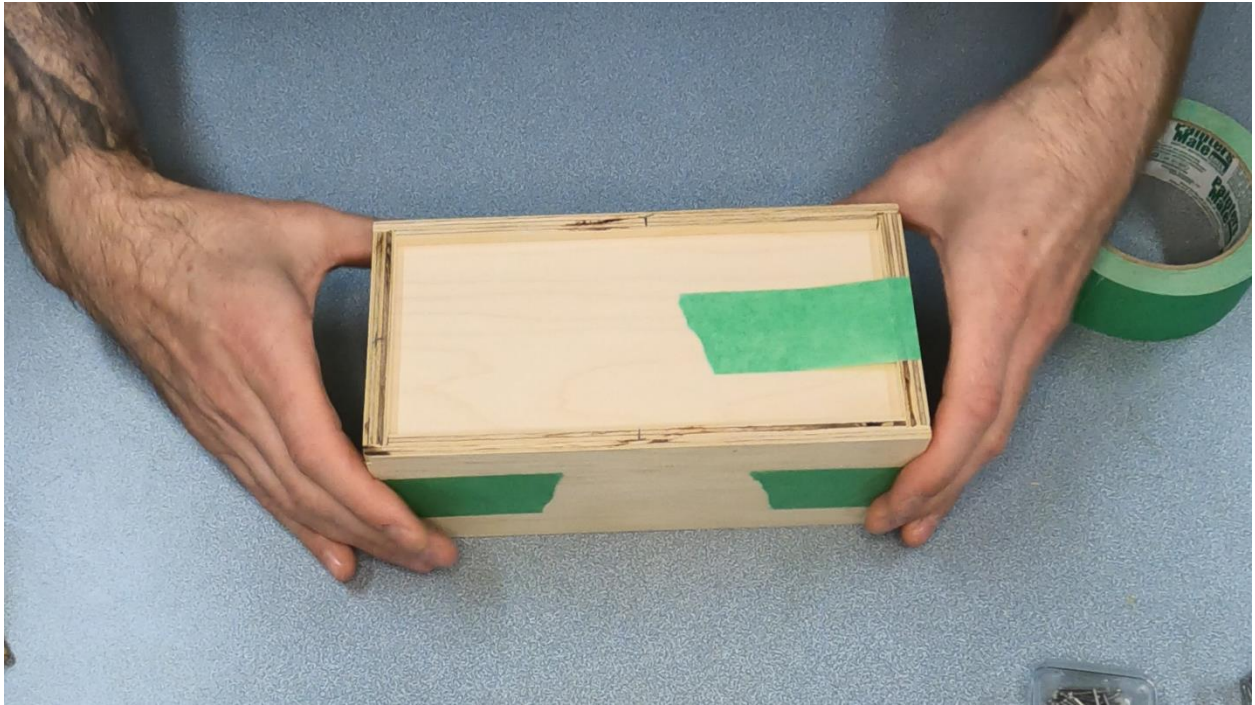

Step 6: Finishing Nails (7:57)

Finishing nails will go through the long sides into the short sides.



Draw a line using your ruler in the middle of the where the nails will go into the short side pieces.

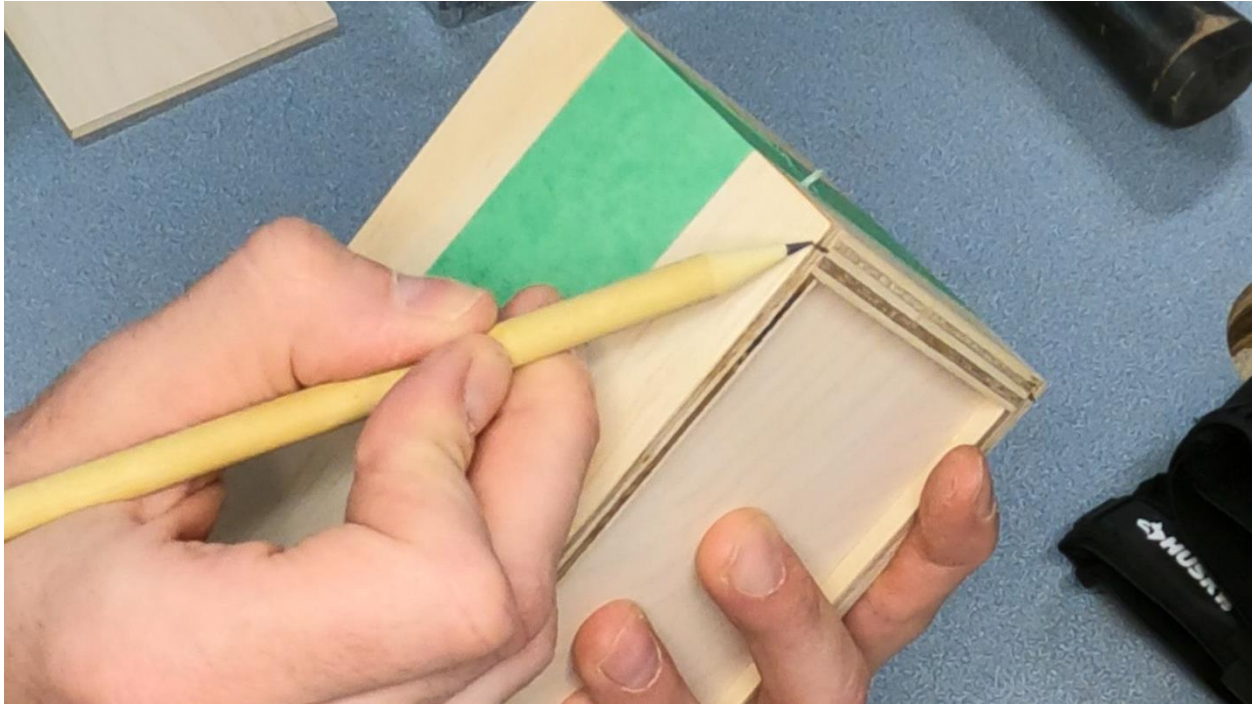

Front of the box - Measure 3cm down on the top front of the box and 2cm up from the bottom of the box



Back of the box - Measure 2cm down on the top front of the box and 2cm up from the bottom of the box

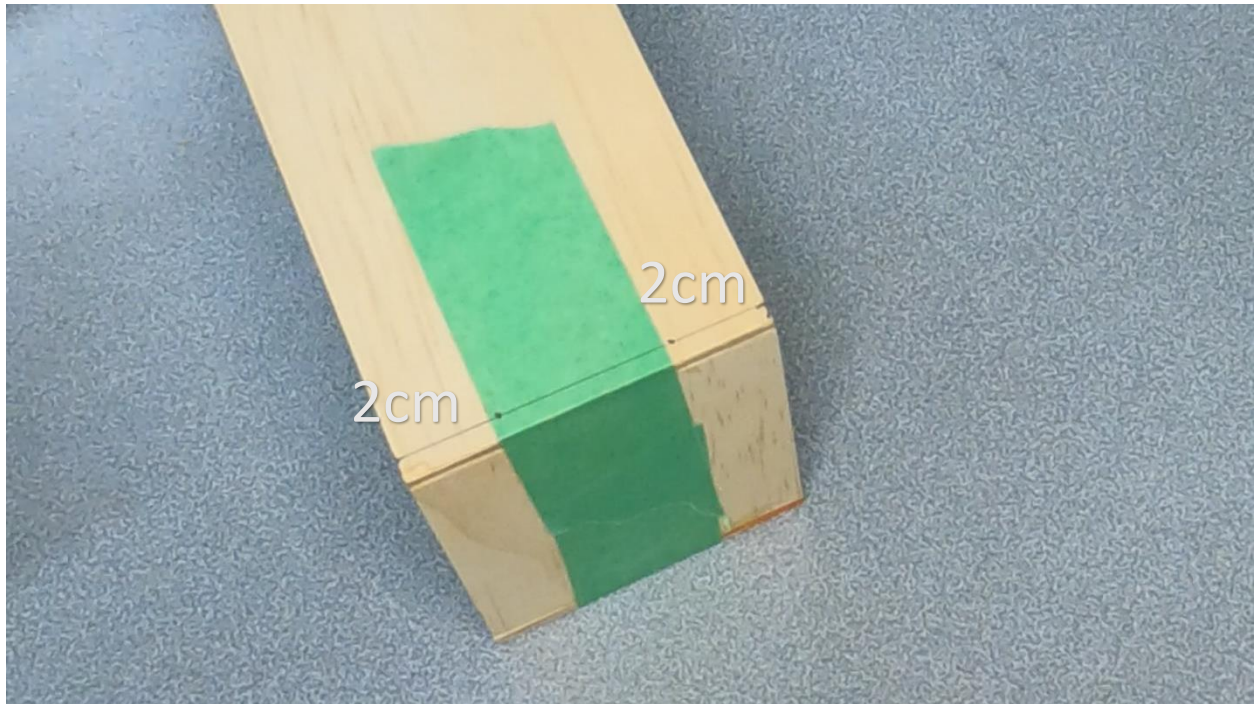

Make sure your Safety Glasses and Gloves are on

Hammer in 2 finishing nails per side, 8 total

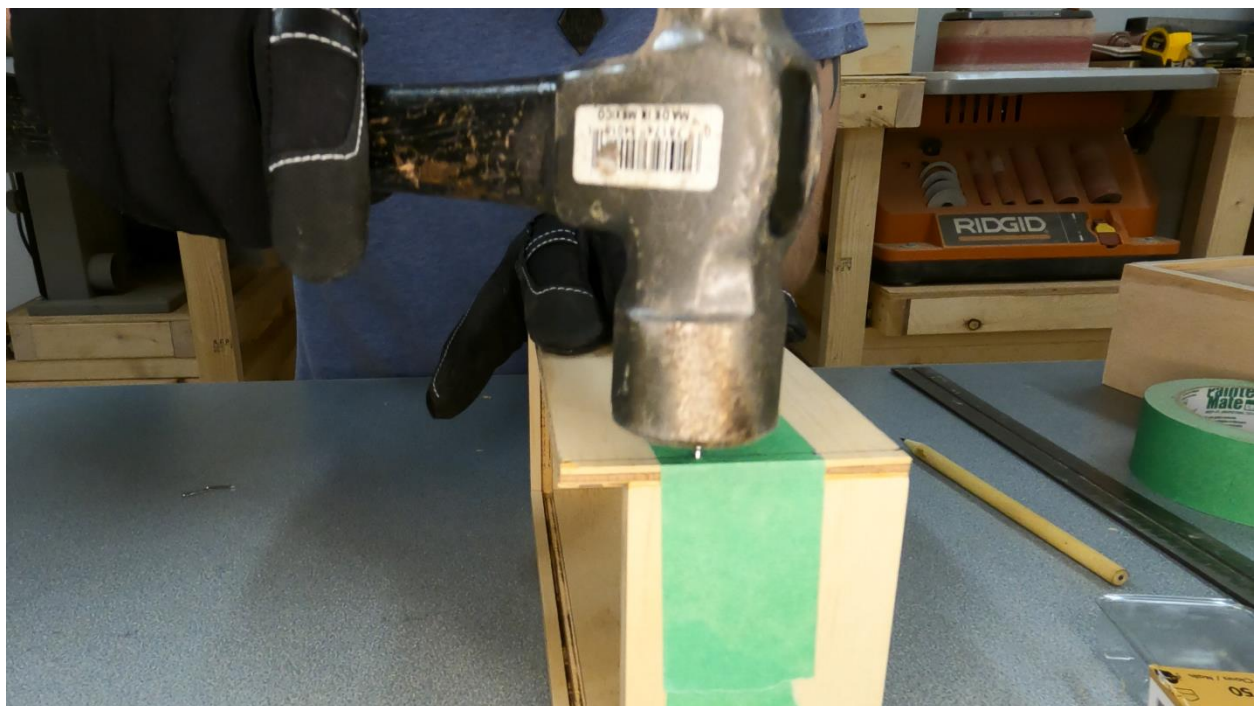

Step 7: Finishing Step (9:05)

Remove the tape and give your box one final sanding to remove any excess glue, pencil lines and make sure the corners are smooth.

